

GARANTIJA dvylika mėn.

Dušo kabina/Vonia Modelis: _____

PIRKIMO DATA _____ PARDAVĖJAS _____

GARANTINIO REMONTO TAISYKLĖS

1. Būtinios sąlygos garantiniam remontui:

- 1.1. Nurodyta pardavimo data, pardavėjo pavardė ir parašas, spaudas, pirkimo čekis arba sąskaita, pateikiamas garantinis pažymėjimas, nurodyta prietaiso sumontavimo data ir montavimo įrodantis dokumentas,
- 1.2. Sugedęs įrenginys transportuojamas pirkėjo sąskaita, pridėdant reikalingus dokumentus.
2. Esant sudėtingam gedimui, remontas gali tęstis 30 dienų.
3. Atlikus remontą, pirkėjas privalo atsiimti prietaisą per 6 mėn laikotarpį.; kitu atveju prietaisas nebebus saugomas ir grąžinamas.
4. Pirkėjas turi teisę reikalauti prietaiso pakeitimu nauju jeigu:
 - 4.1. Garantijos galiojimo metu buvo atlikti 5 remontai,
 - 4.2. Nustatoma, kad remontas toliau neįmanomas.
5. Mes garantuojame nemokamą remontą jeigu:
 - 5.1. Nėra mechaninių pažeidimų ir pakeitimų,
 - 5.2. Nebuvo naudojamas komerciniais tikslais,
 - 5.3. Įrenginys sumontuotas ir eksploatuojamas teisingai,
 - 5.4. Garantija negalioja vandens išbėgimo sistemoms.
 - 5.5. Dušo padą rekomenduojama papildomai sutvirtinti, jei apkrova didesnė nei 110 kg.
5. Garantinis remontas atliekamas UAB „Euroliuksas“ atstovybėse.

Įrengti dušo kabiną/vonią gali tik pardavėjo/gamintojo įgaliotas atstovas.

SU GARANTINIO REMONTO TAISYKLĖMIS SUSIPAŽINAU

Pirkėjas _____ parašas _____

UAB “Euroliuksas” atstovybės:

Žaltakalnio g. 20a., Plungė
Stoties g. 5, Plungė
Viršuliškių g. 42a, Vilnius,
Savanorių pr. 214A, Kaunas,
Kniaudiškių g. 2a, Panevėžys,
Daukanto g. 4c, Šiauliai
Radvilų g. 53, Kėdainiai

mob. 865799 413 e-mail: plunge@euroliux.lt
tel./fax. 844872015, info@euroliux.lt
tel./fax. 852653083, vln.salonas@euroliux.lt
tel./fax. 837707676, giedre@euroliux.lt
tel./fax. 845443543, panevezys@euroliux.lt
tel./fax. 841423412, siauliai.salonas@euroliux.lt
tel./fax. 834756448, kedainiai@euroliux.lt

R8B03
900x900x1950



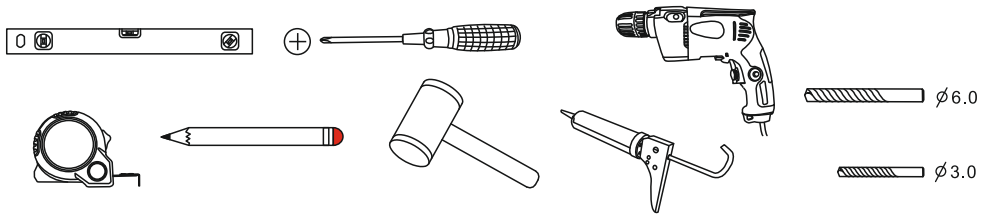

A		X2
B		X2
C		X2
D		X2
E		X1
F		X4
G		X2

H		X4
I		X4
J		X1
K		X2
L		X16
M		X8
N		X4

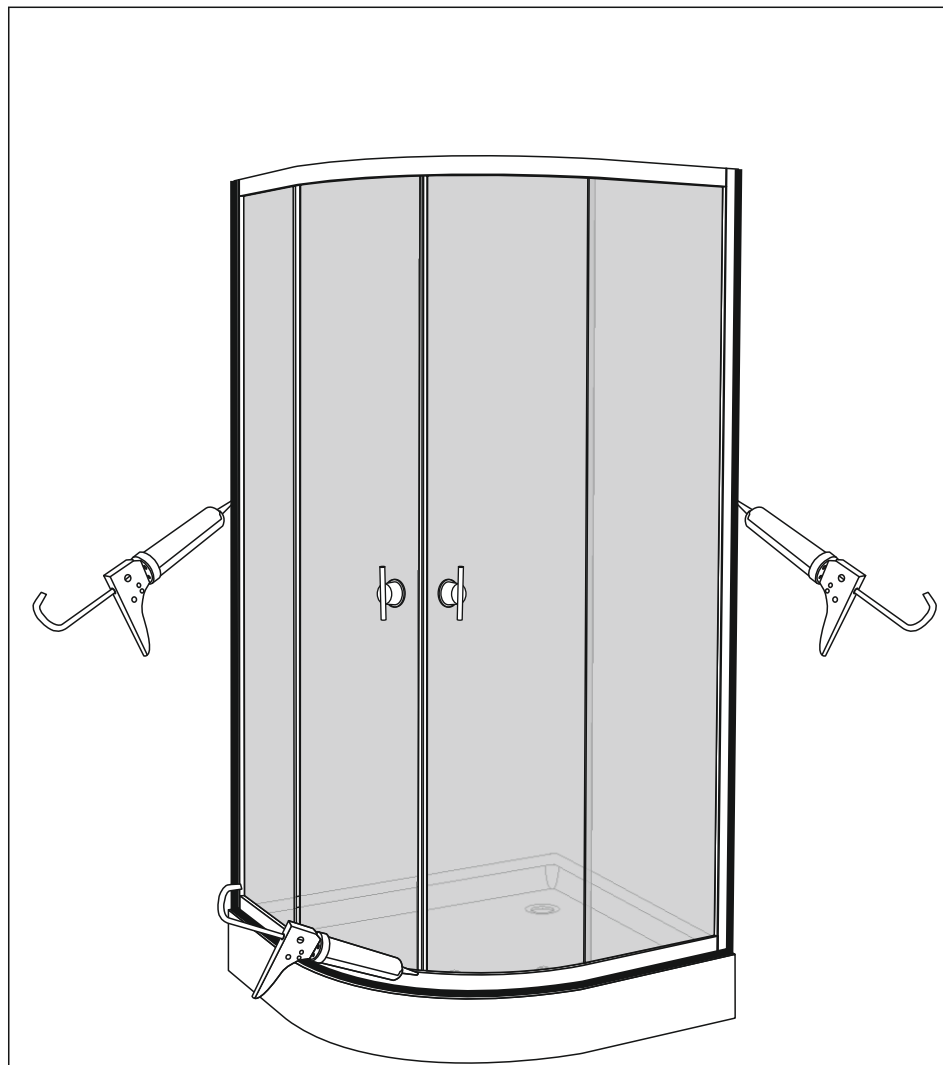
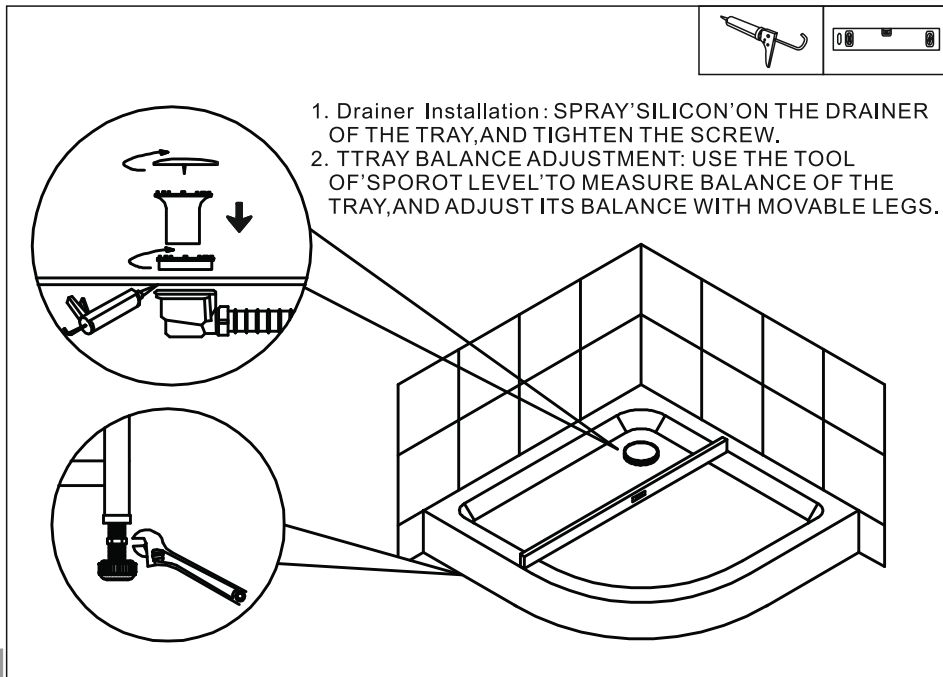

1. PUT SILICON AROUND THE ALUMINUM FRAME AFTER INSTALLATION. TO PREVENT WATER LEAK TO OUTSIDE FROM SHOWER ROOM.

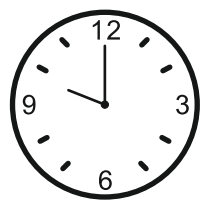

IT is prohibited to use within 24 hours

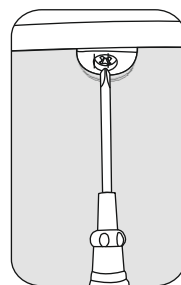
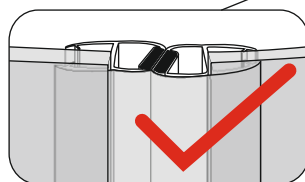
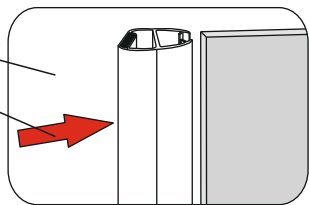
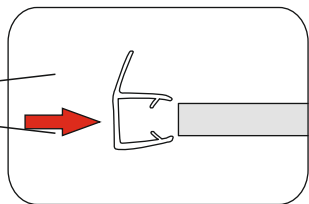
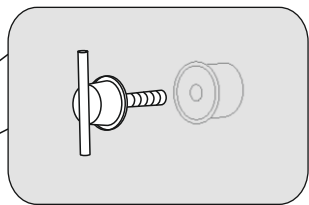
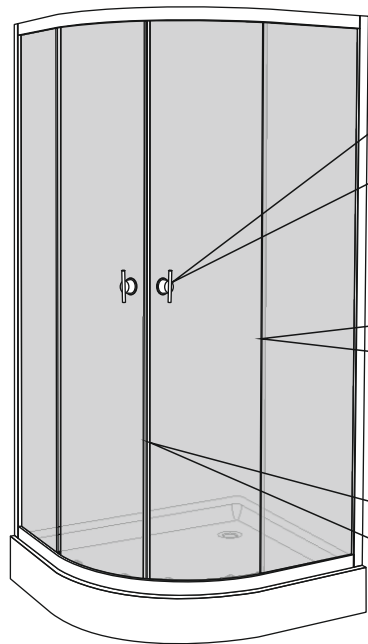

1. DOOR HANDLE INSTALLATION.
2. WATERPROOF SEAL INSTALLATION.
3. DOOR MAGNET SEAL INSTALLATION:
WHEN THE MAGNET SEAL CAN NOT ABSORB
EACH OTHER.PLEASE ADJUST UP ROLLER SCREW.

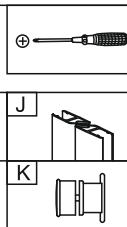

1. USE SCREW(ST 4X30)TO CONNECT
ALUMINUM ALLOY FRAME AND ARCH FRAME.

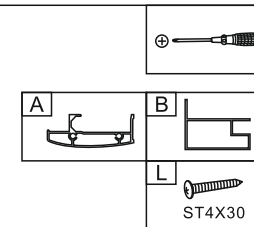
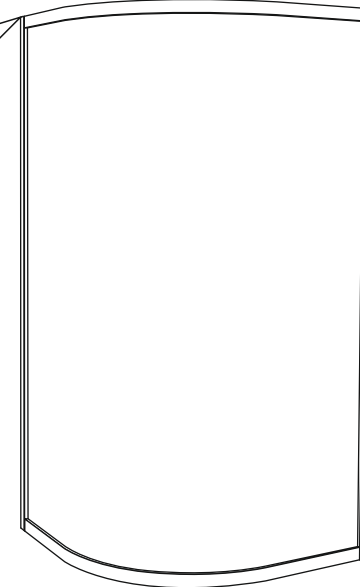
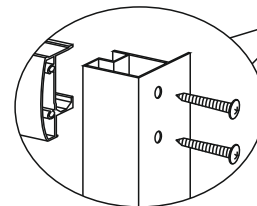

1. RUBBER SEAL COVER THE EDGE OF FLASS,
AND INSERT THE GLASS INTO THE GROOVE
OF ALUMINUM FRAME.
2. FIXED THE PRESS BLOCK OF DOOR GLASS:
FIRST,TO FIND THE LOCATION OF THE PRESS BLOCK
ON THE ARCH FRAME,AND THEN DRILL THE HOLE ONIT.

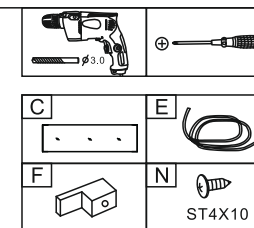
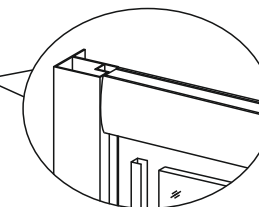
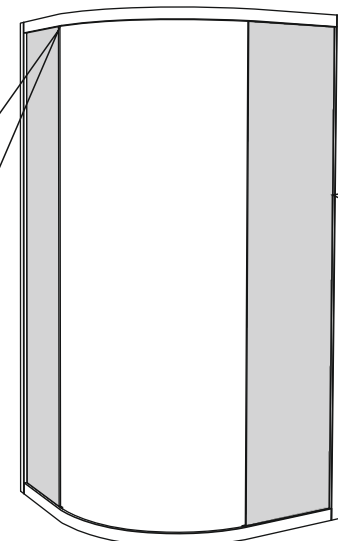
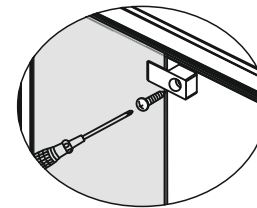
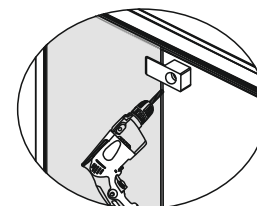

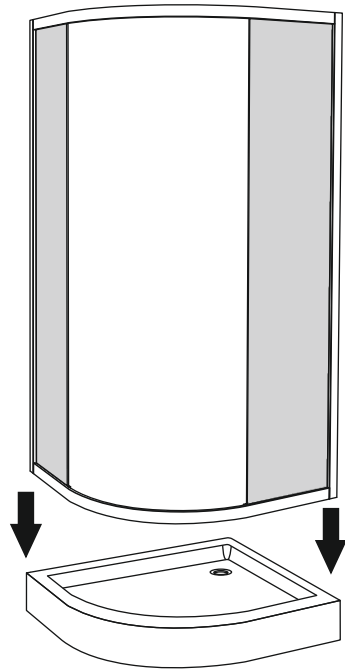

1. PUT THE INSTALLED GLASS SHOWER SCREEN ONTO THE TRAY.

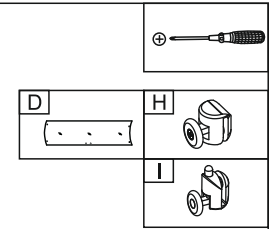
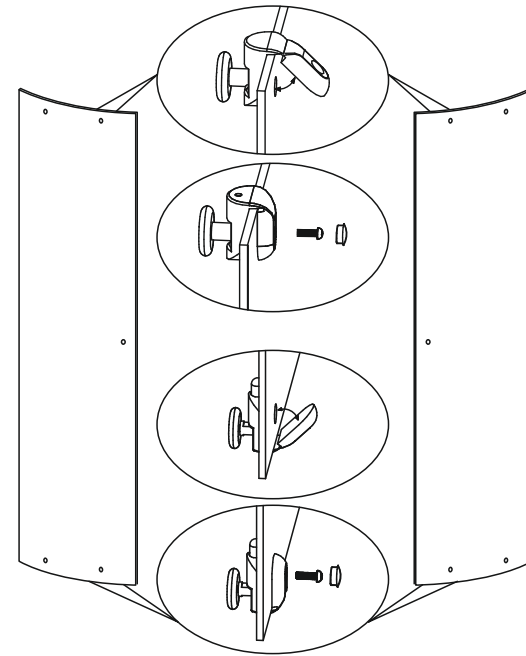

1. INSTALL UP ROLLER AND DOWN ROLLER TO THE DOOR GLASS.

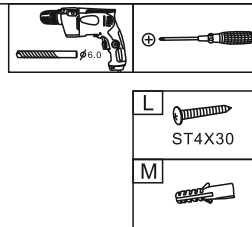
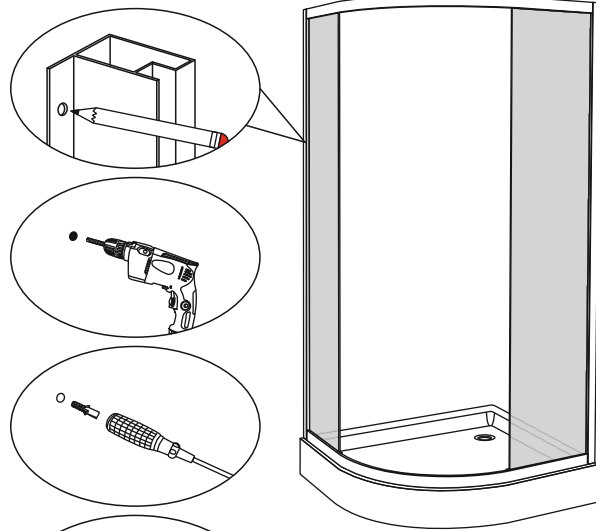

1. FIXED THE FRAME STRUCTURE: FIRST, TO ENSURE LEFT AND RIGHT SIZE DISTANCE IS THE SAME. MAKE MARKS ON THE FRAME AND WALL. AND THEN DRILL THE HOLE ON FRAME AND WALL. INSERT 'EXPANSION SCREWS' INTO THE WALL. FINALLY, USE SCREW (ST4X30) TO TIGHTEN IT.

1. INSERT UP ROLLER INTO THE UP ARCH FRAME, AND THEN PRESS DOWN ROLLER ADJUST BUTTON, TO PUT DOWN ROLLER INTO THE GROOVE OF DOWN ARCH FRAME.

